

## Product information

# 87 21 250

## KNIPEX Cobra® QuickSet Hightech Water Pump Pliers

DIN ISO 8976



- Fully open, push, grab!
- Additional fast adjustment on the workpiece by sliding the pliers handle
- Combines the proven, reliable locking of the hinge bolt with an additional push function which makes it easier to work in very confined and inaccessible areas
- The adjustment directly on the workpiece is possible by simply sliding the pliers handle
- Reliable locking of the hinge bolt with the first workload. The gripping width of the pliers is then fixed and can only be adjusted by pressing the button.
- To re-activate the sliding function, the hinge bolt must be released by pressing the push button and the pliers must be completely opened again
- Chrome vanadium electric steel, forged, multi stage oil-hardened

### General

Article No.	87 21 250
EAN	4003773072775
Pliers	grey atramentized
Head	polished
Handles	with non-slip plastic coating
weight	345 g
Dimensions	250 x 92 x 50 mm
Standard	DIN ISO 8976

### Technische Attribute

Adjustment positions	25
Capacity for pipes, inches (diameter)	Ø 2 Inch
Capacities for nuts	46 mm
Capacities for pipes (diameter)	Ø 50 mm

### Classification

eCl@ss 5.1.4	21040301
ETIM 5.0	EC000164
ETIM 6.0	EC000164
proficl@ss 6.0	AAA936c004
UNSPSC 13.1	27112112

*technical change and errors excepted*

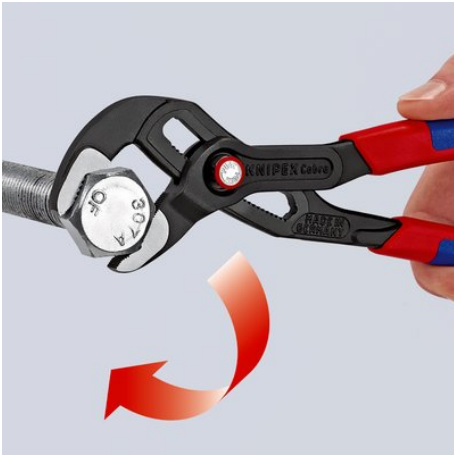

Hinge bolt locks itself with the first workload

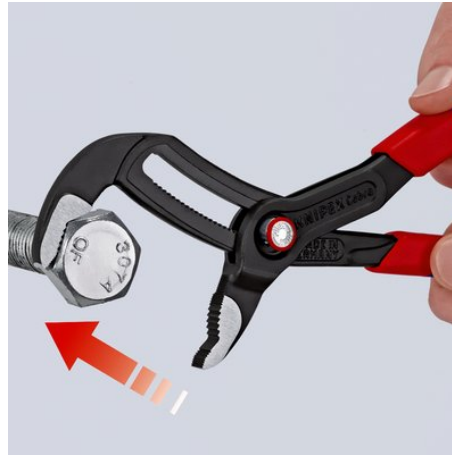

Press the button – open pliers completely